

1 2 3 4 5 6 7 8

A
B
C
D
E
F
G
H

A
B
C
D
E
F
G
H

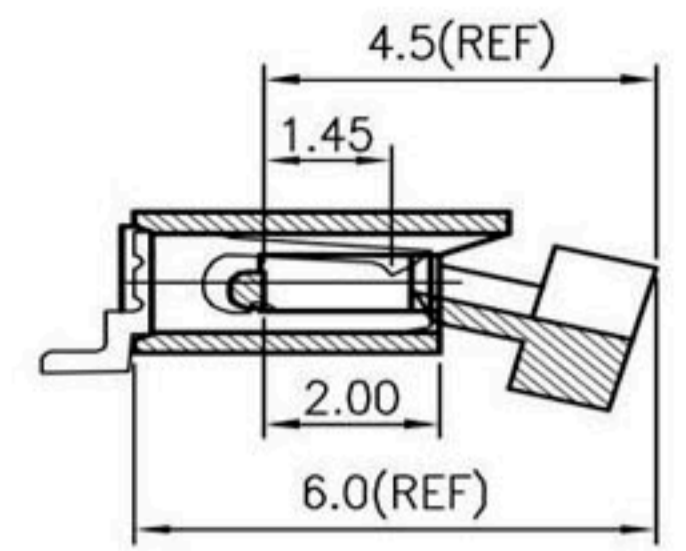
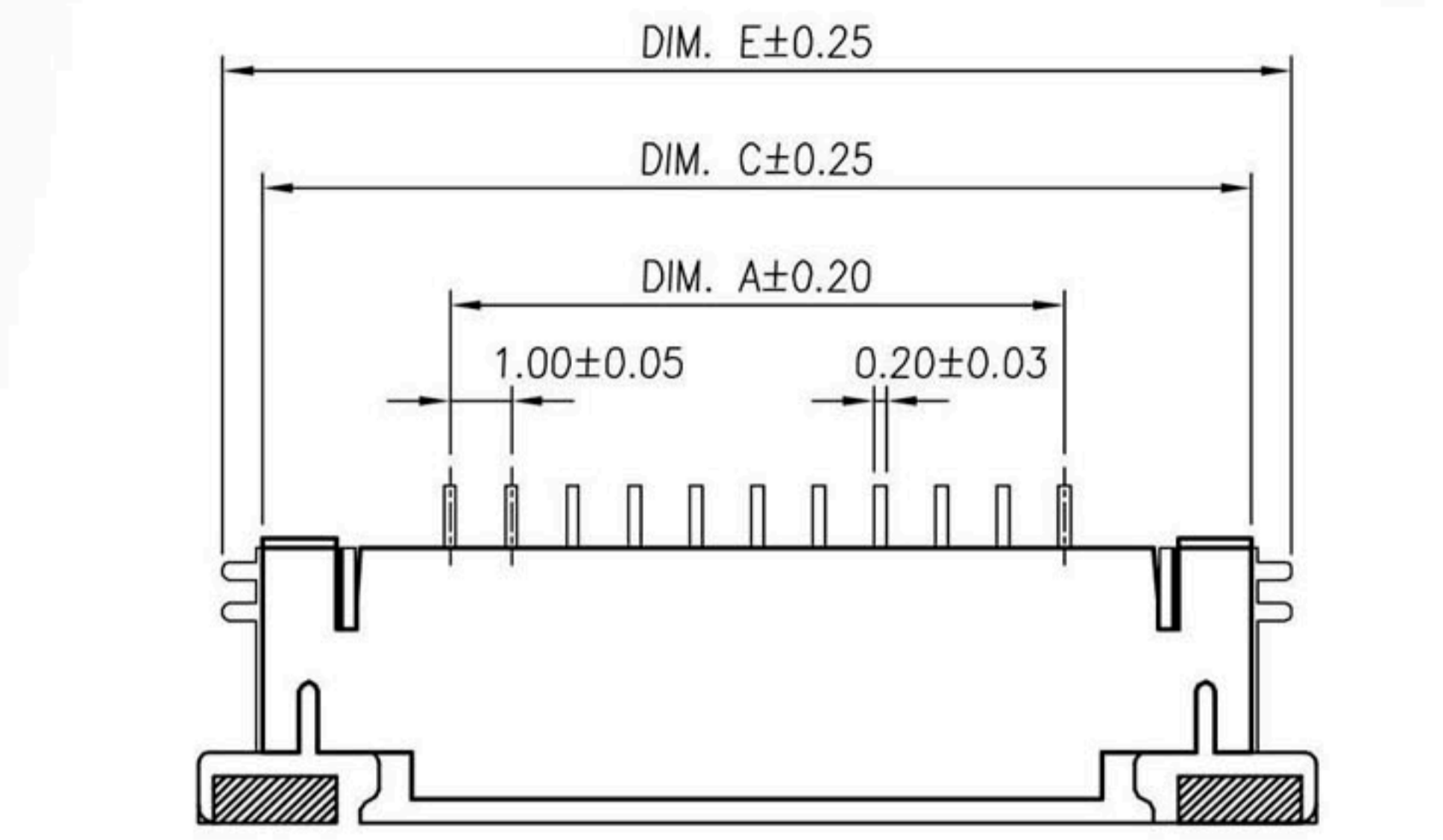

SECTION A-A

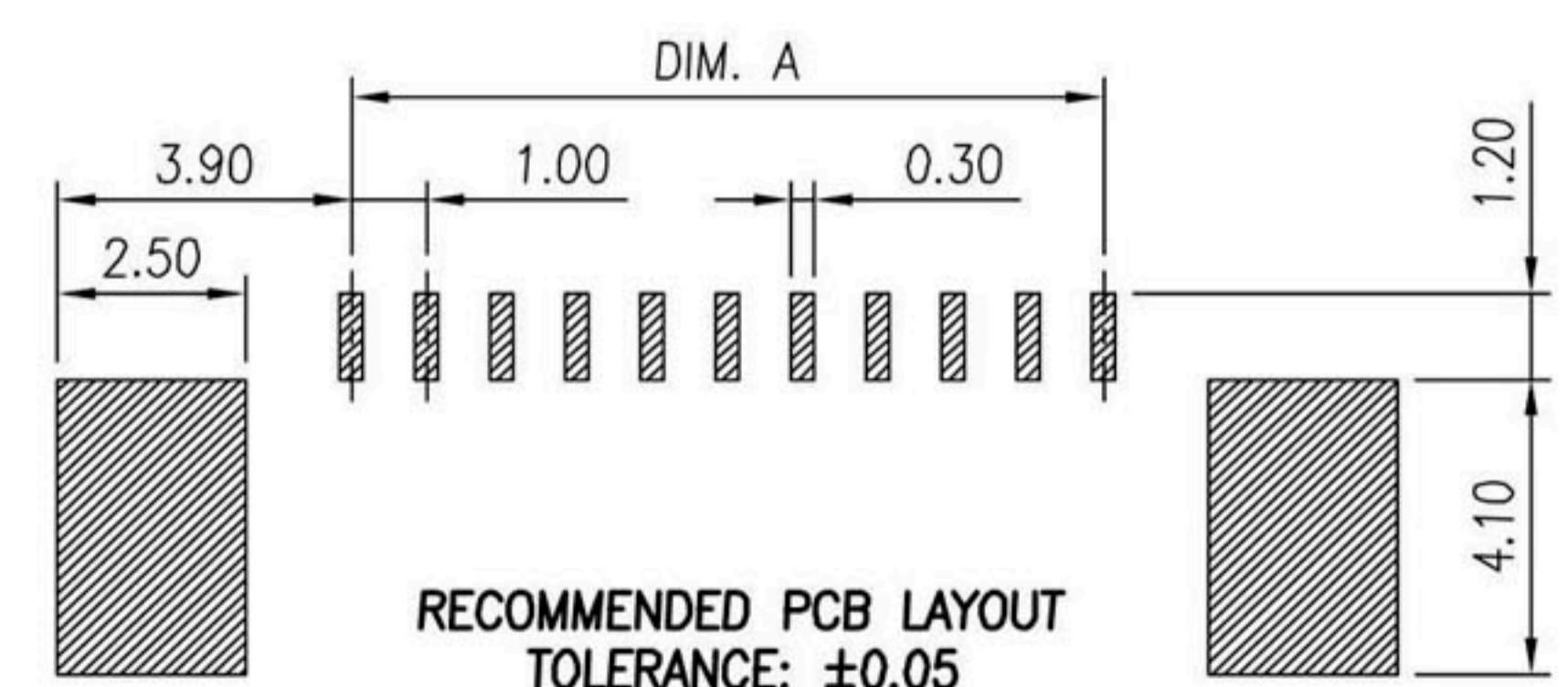
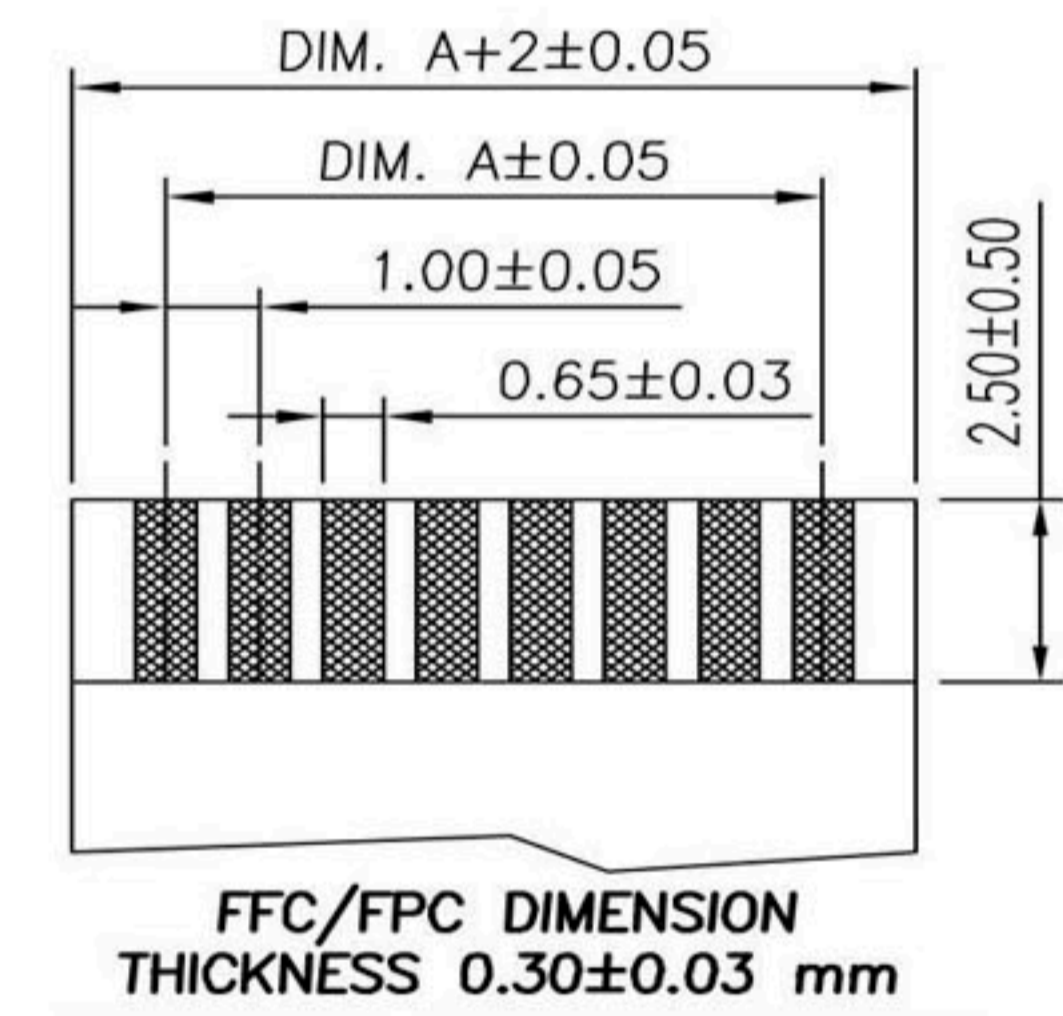
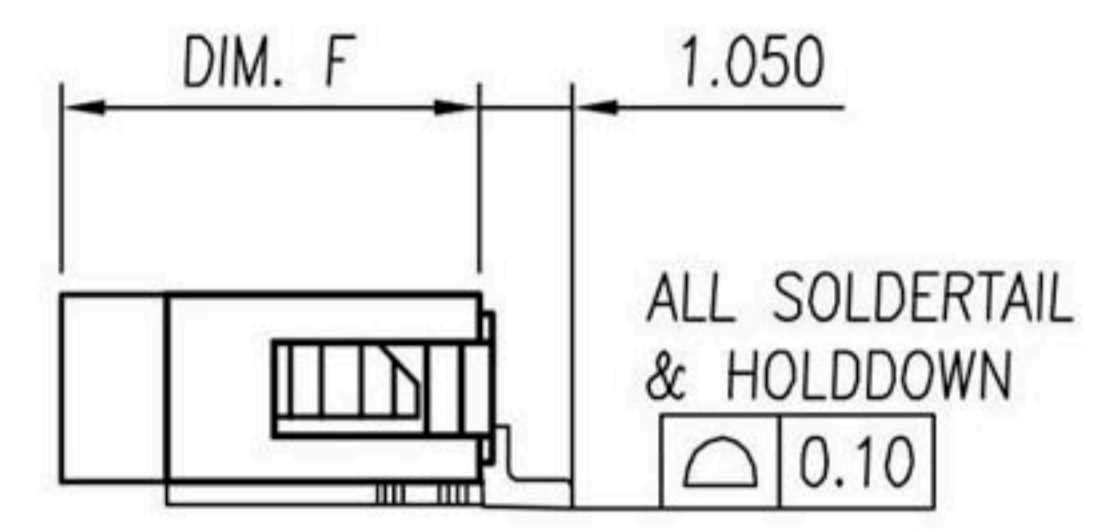
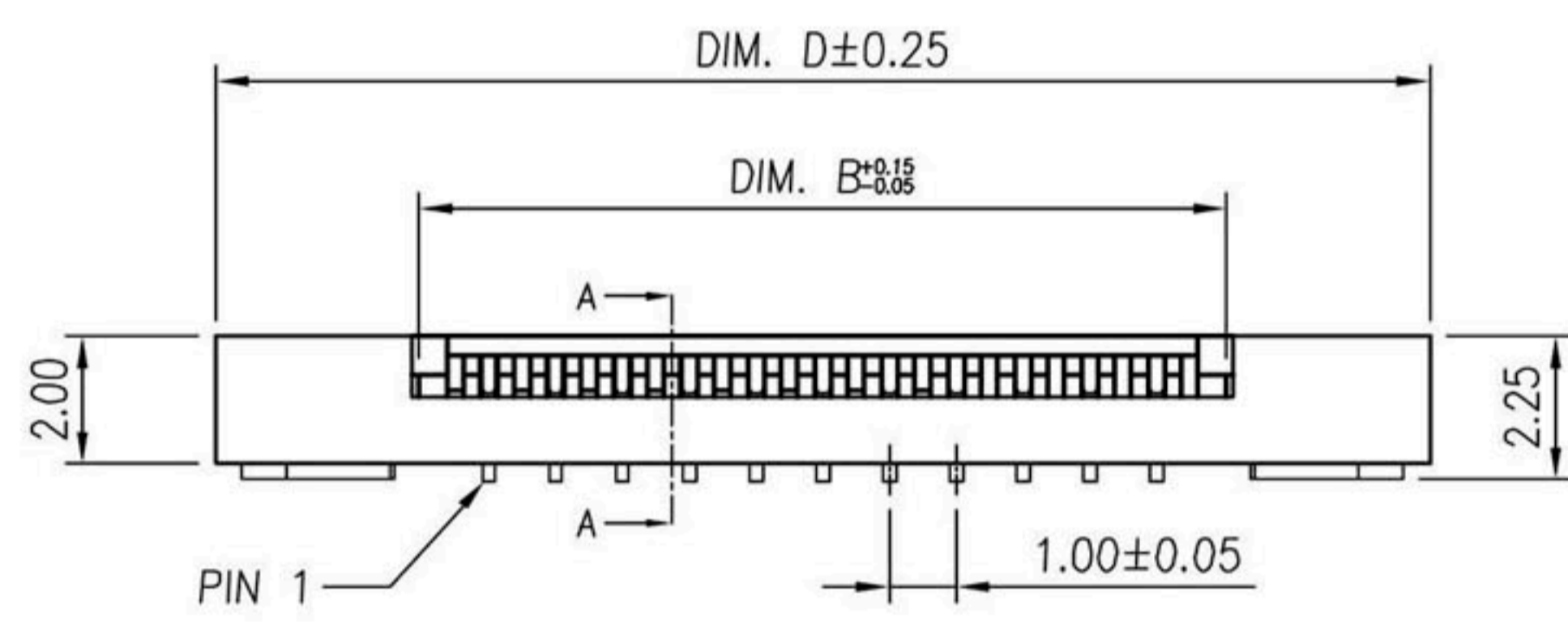

RECOMMENDED PCB LAYOUT TOLERANCE: ±0.05

- RATINGS**
- A. Voltage: 50 VAC .
 - B. Current: 0.5 A Max
 - C. Temperature: -20 °C to 85 °C

ELECTRICAL REQUIREMENT

Contact Resistance	[20] m Ohm Max. (Initial) [30] m Ohm Max. (Final)	Subject mated contacts assembled in housing to 20mV Max open circuit at 10mA Max. EIA-364-6B.
Dielectric withstanding Voltage	No creeping discharge or flashover shall occur. Current leakage: 0.5 mA MAX	[250]VAC for 1minute Test between adjacent circuits of unmated connector. EIA-364-20B
Insulation Resistance	[50] M Ohm Min.	Impressed voltage 500 VDC. Test between adjacent circuits of unmated connector. EIA-364-21C.

NOTE:

- 1.MATERIAL:
HOUSING: HIGH TEMPERATURE THERMOPLASTIC.
ACTUATOR: HIGH TEMPERATURE THERMOPLASTIC.
TERMINAL: COPPER ALLOY.
HOLDDOWN: COPPER ALLOY.
- 2.FINISH:
TERMINAL: 100u" MIN. TIN PLATING OR G/F GOLD PLATING WITH 50u" MIN. NICKEL UNDERPLATED OVERALL.
HOLDDOWN: 100u" MIN. TIN PLATING WITH 50u" MIN. NICKEL UNDERPLATED OVERALL.

■ DIMENSION TABLE

Pos.	Dimension					
	A	B	C	D	E	F
4	3.00	5.10	9.10	11.20	10.40	4.30
5	4.00	6.10	10.10	12.20	11.40	4.30
6	5.00	7.10	11.10	13.20	12.40	4.30
7	6.00	8.10	12.10	14.20	13.40	4.30
8	7.00	9.10	13.10	15.20	14.40	4.30
9	8.00	10.10	14.10	16.20	15.40	4.30
10	9.00	11.10	15.10	17.20	16.40	4.30
11	10.00	12.10	16.10	18.20	17.40	4.30
12	11.00	13.10	17.10	19.20	18.40	4.30
13	12.00	14.10	18.10	20.20	19.40	4.30
14	13.00	15.10	19.10	21.20	20.40	4.30
15	14.00	16.10	20.10	22.20	21.40	4.70
16	15.00	17.10	21.10	23.20	22.40	4.70
17	16.00	18.10	22.10	24.20	23.40	4.70
18	17.00	19.10	23.10	25.20	24.40	4.70
19	18.00	20.10	24.10	26.20	25.40	4.70
20	19.00	21.10	25.10	27.20	26.40	4.70
21	20.00	22.10	26.10	28.20	27.40	4.70
22	21.00	23.10	27.10	29.20	28.40	4.70
23	22.00	24.10	28.10	30.20	29.40	4.70
24	23.00	25.10	29.10	31.20	30.40	4.70
25	24.00	26.10	30.10	32.20	31.40	4.70
26	25.00	27.10	31.10	33.20	32.40	4.70
27	26.00	28.10	32.10	34.20	33.40	4.70
28	27.00	29.10	33.10	35.20	34.40	4.70
29	28.00	30.10	34.10	36.20	35.40	4.70
30	29.00	31.10	35.10	37.20	36.40	4.70

RoHS Compliant		HSM 玄茂科技股份有限公司	
		HSUAN MAO TECHNOLOGY CO., LTD.	
APPD. 核准		TOLERANCE 容許公差	PART NAME 品名
DWG. 製圖	Hedy	.0 ± 0.3 .00 ± 0.2 ANG. ± 2°	FPC/FFC ZIF 1.0mm SMT TYPE HORIZONTAL TYPE XXP UPPER CONTACT REEL PACKING TIN PLATING IVORY COLOR ROHS
DATE 制表日	2012/09/03	UNIT 單位	PART NO.
		M M	料號
		PAGE 張數	C3931-XXUTRI00R
		1 OF 1	
		REV. 版本	
		B	

1 2 3 4 5 6 7 8